

# Castle Tile, Marble & Granite Edge Profile Guide

561 819-5777    www.marblecastle.com    info@marblecastle.com  
950 S.W. 17th Ave, Delray Beach, FL 33444

## Single Edges

Name: **Flat Polish**

Thickness: 1 1/4" or 3/4"

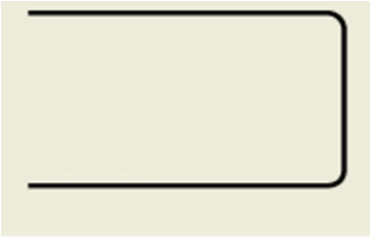

Name: **1/4 Bevel**

Thickness: 1 1/4" or 3/4"

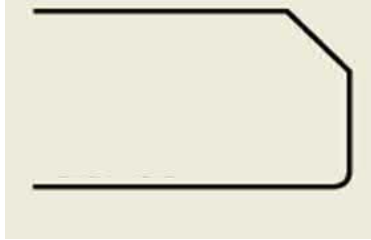

Name: **Half Bevel**

Thickness: 1 1/4" or 3/4"

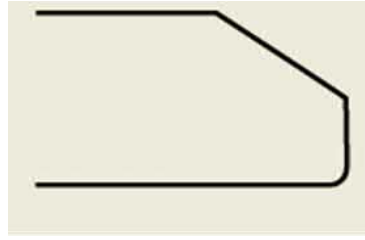

Name: **Full Bullnose**

Thickness: 1 1/4" or 3/4"



Name: **1/4 Bevel Top & Bottom**

Thickness: 1 1/4" or 3/4"

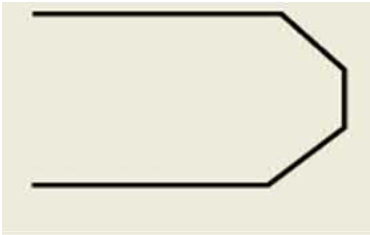

Name: **Ogee Flat**

Thickness: 1 1/4" or 3/4"

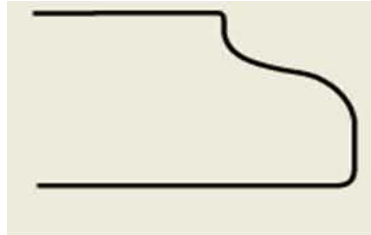

Name: **Ogee Round**

Thickness: 1 1/4" or 3/4"

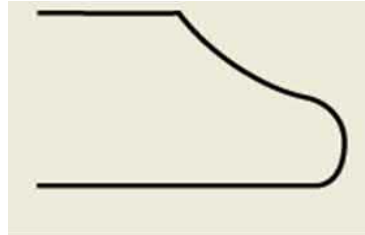

Name: **Half Bull Nose**

Thickness: 1 1/4" or 3/4"

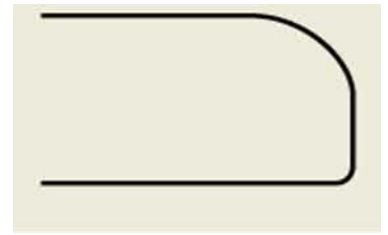

## Laminated Edges

Name: **Full Bull Nose**

Thickness: 1 1/2" or 2 1/2"

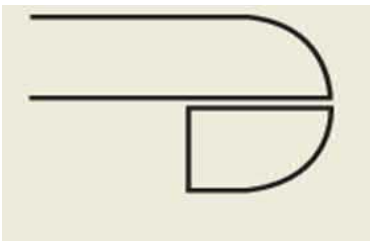

Name: **Half Bull Nose**

Thickness: 1 1/2" or 2 1/2"

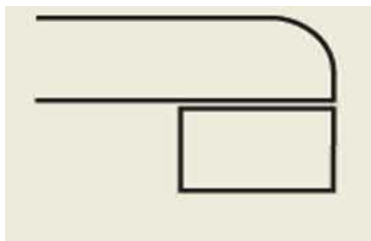

Name: **Flat Polish**

Thickness: 1 1/2" or 2 1/2"

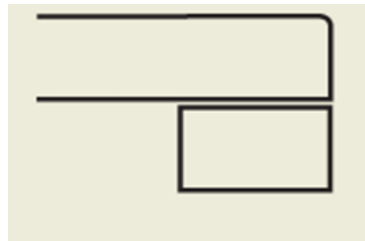

Name: **Bevel**

Thickness: 1 1/2" or 2 1/2"

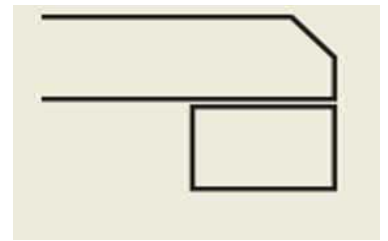

Name: **Bevel Top & Bottom**

Thickness: 1 1/2" or 2 1/2"

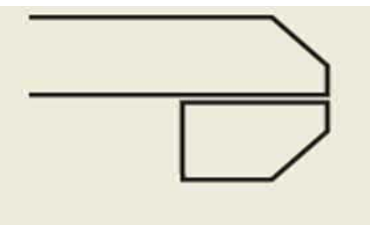

Name: **Miter Edge**

Thickness: 1 1/2" or 3 1/2"

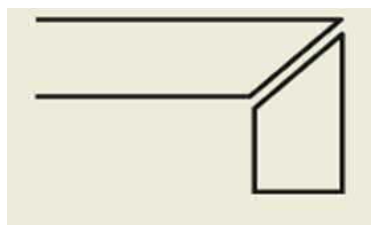

Name: **Ogee Full Bull Nose**

Thickness: 1 1/2" or 2 1/2"

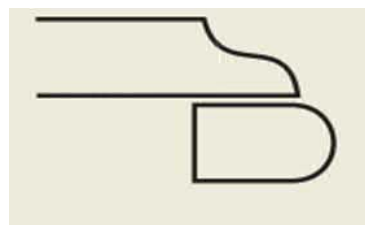

Name: **Ogee Flat**

Thickness: 1 1/2" or 2 1/2"

